

*** Use one brace when $H \leq 18"$
 Use two braces when $18" < H < 48"$
 Use three braces when $H \geq 48"$

** Position of brace may be varied to match
 Pre-drilled mounting holes in panel

SIGN BRACING PLACEMENT

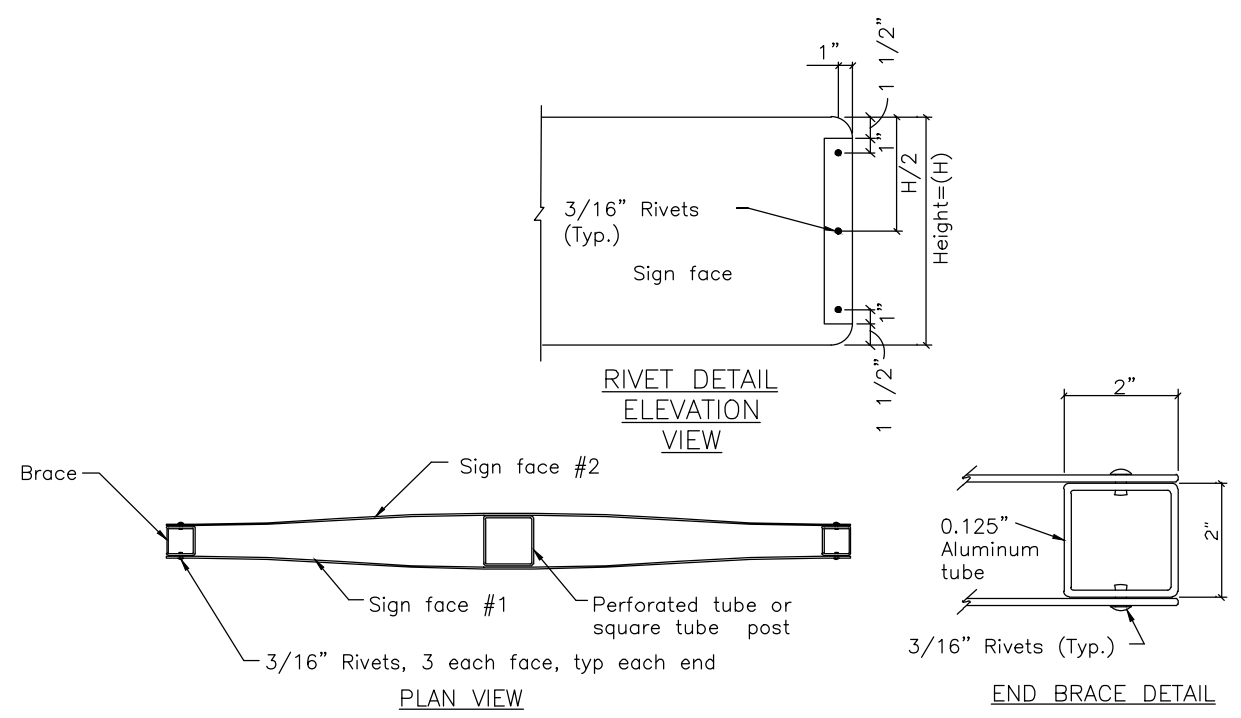

SMALL STREET NAME SIGN (D3-1, D3-1A, D3-1D) BRACING DETAILS

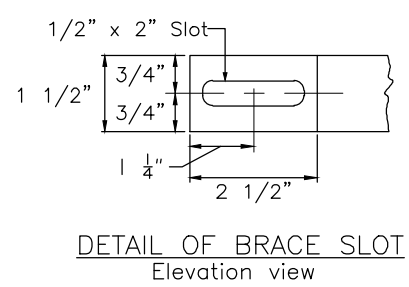

DETAIL OF BRACE SLOT
Elevation view

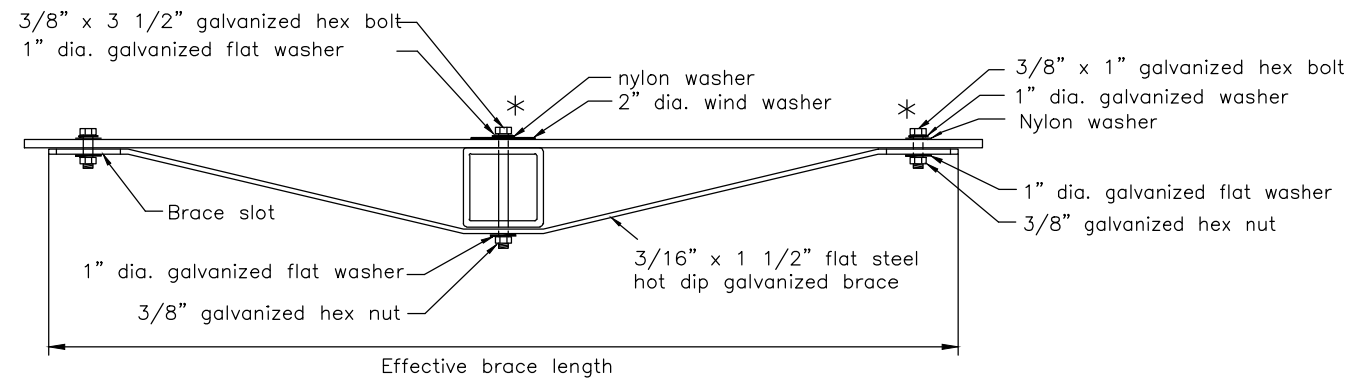

TUBE POST SIGN BRACING SECTION A-A
Plan view

* Adjust location of bracing so that bolts and washers will miss the sign legend

Sign Width(W)	Effective Brace Length		
	Warning	Yield	Other
30"	36"	24"	24"
36"	42"	30"	30"
42"	48"	-	36"
48"	Two posts	36"	42"

< 30" No bracing required and use square tube

Note: Drawing not to scale

State of Alaska DOT&PF
 ALASKA STANDARD PLAN

BRACING FOR SIGNS
 MOUNTED ON SINGLE POST

Adopted as an Alaska Standard Plan by: *Carolyn Morehouse*
 Carolyn Morehouse, P.E.
 Chief Engineer

Adoption Date: 7/17/2020

Last Code and Stds. Review
 By: WTH Date: 7/8/2020

Next Code and Standards Review date: 7/8/2030

S-01.02